

.455 REVOLVER CARTRIDGES

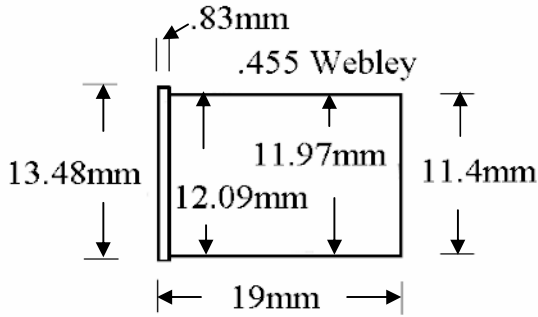

Australia adopted the .455 Webley revolver around 1922 and commenced manufacturing ammunition for it in 1922. Only the Mk II and the Mk VI were ever made in Australia as far as I know at this time. The Webley served the Australians up until 1943 when it was phased out in favour of the .380 Enfield. Another backward step as the smaller cartridge has even less power than the .455. At least the Webley had the advantage of a big, fat projectile if and when you managed to hit the target.

The metric designation for this cartridge is 11.4x19R

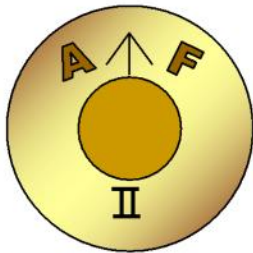

Mk II ball made at CAC factory whilst under lease. 1922

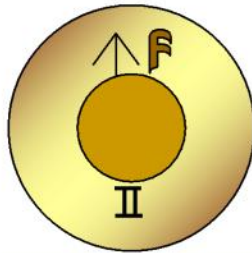

Mk II ball made in CAC factory whilst under lease in 1925.



Mk II made at MQ in 1942 only.

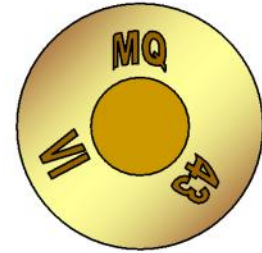

Mk VI ball made at Rocklea in Queensland 1942-43

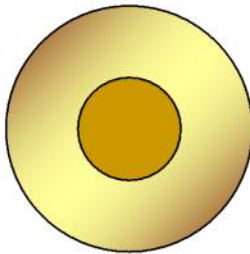

Ballistic standard?

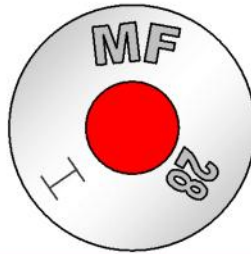

Drill cartridge made at MF in 1928 only.



Mk II blank made at MF in 1941 only.



Mk II made at MF. 1927-1941



Mk II ball made at MF just after the purchase of the facility. 1927.



Mk VI Ball



Mk II Ball